



REQUEST FOR PROPOSALS

PROJECT NAME:
Sand Springs Community Mural
Project
Due Date: June 26, 2026

ISSUED BY: OSAGE CASINO
1211 West 36th Street North, Tulsa, OK 74127
Phone: 918-699-7849 • Fax: 918-699-7790

Osage Casinos operates seven state-of-the-art gaming and entertainment properties in and around Osage County. One of the largest employers in northeast Oklahoma, Osage Casinos offers extensive gaming opportunities, venues for local and national entertainment, banquet space for event rentals, hotels, restaurants, convenience stores, and more.

Founded in 2002, Osage Casinos plays a critical role in providing income to support the needs of the Osage Nation and the state. The Osage Nation uses revenues from its casinos to:

- Fund tribal government and programs.
- Provide for the general welfare of the tribe and its members.
- Promote tribal economic development.
- Support charitable organizations.
- Help fund operations of local government agencies of the Osage Nation.

The business entity is governed by the Osage Nation Gaming Enterprise Board. More information is available at osagecasinos.com

Section I. General Notice

Inquiries regarding the request for proposal shall be directed in writing, on or before June 23rd, 2026, to the following:

Questions:

Jeff Bailey
Director of Operations
1211 W. 36th Street North
Tulsa, OK 74127
Jeff.bailey@osagecasinos.com

Submittals:

Stephanie Parker
Procurement Officer
1211 West 36th St North
Tulsa, OK 74127
Stephanie.parker@osagecasinos.com

No oral requests will be accepted, and no oral answers/responses will be given. To ensure the fair and consistent distribution of information, all questions will be answered by a Q&A document, which will be posted on the Osage Casino's website (www.osagecasinos.com)

Any revisions to the solicitation will be made only by an addendum issued by the Osage Casino, which will be posted on the Osage Casino's website.

Osage Casinos is soliciting competitive sealed proposals from qualified artists or artist teams to design and install a large-scale community mural.

Response to Request for Proposal shall be submitted as follows:

Date & Time: No later than 4:00 p.m. **CST on June 26th, 2026.**

Proposals received after that time will be considered null and void and will not receive further consideration. missed deliveries, late or faxed submittals will be considered non-responsive.

Submitting a proposal will represent that you have fully reviewed and fully understand the terms of the RFP.

Each proposal shall be submitted with three (3) printed sets (8x11) and one (1) electronic set in PDF format on CD/DVD/THUMB DRIVE to Osage Casinos Procurement Officer Stephanie.parker@osagecasinos.com. Proposals shall be submitted in an envelope clearly marked indicating the Project Title.

Awarding

- I. Bid will be awarded within 15-30 days following the submission deadline, subject to finalist presentations and internal approvals.
- II. All bidders will be notified in writing when the bid has been awarded and/or is no longer considered for award.
- III. Award of the contract is subject to determination that the vendor is eligible to contract with the Osage Casinos.
- IV. The Owner and its authorized representatives will review all proposals received, and may contact bidders to request further information, either in written form or in the form of a presentation to the Owner. The Owner may accept any given proposal as submitted or may negotiate with bidder to establish terms most advantageous to the Owner. The decision of the Owner shall be final and not subject to appeal.

Section II Project Description

General Background:

The Osage Casinos is wholly owned unincorporated enterprise of the Osage Nation, a federally recognized Indian Tribe, and as an instrumentality of the Osage Nation, possesses all the privileges and immunities of the Osage Nation, including its status as a non-taxable entity and its sovereign immunity from unconsented suit. The Osage Gaming Enterprise operates seven casinos throughout the Osage Reservation, known as Osage County.

1. Introduction

The Osage Nation Gaming Enterprise (ONGE), in partnership with the Sand Springs Chamber of Commerce, is seeking qualified artists or artist teams to design and commission a large-scale exterior mural.

The mural will be located on the south-facing exterior wall of the Sand Springs Chamber of Commerce building at:

**109 N. Garfield Avenue
Sand Springs, Oklahoma 74063**

This project is intended as a **community beautification initiative** and a **celebration of 80 years of service** by the Chamber to the Sand Springs community. The mural is not intended to function as commercial signage.

2. The objective is to deliver a visually impactful, **community-centered mural** that reflects the identity, history, and spirit of Sand Springs.

3. Site Details & Dimensions

- **Wall Location:** South-facing exterior wall
- **Dimensions:** Approximately **11 feet high x 94 feet long**
- **Total Area:** ~1,430 square feet

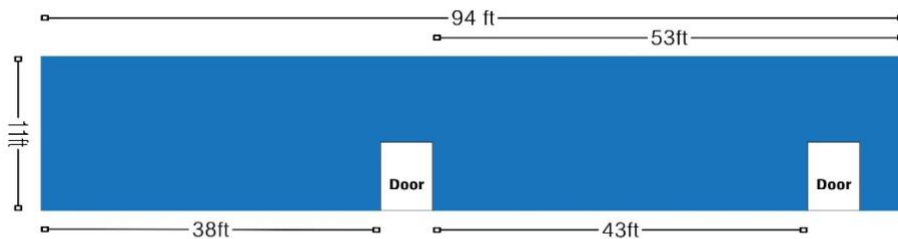



4. Design Requirements

Proposed mural concepts must align with the following creative direction:

4.1 Concept Theme

- Design should reflect a vintage postcard inspired aesthetic
- Must prominently feature the name: “**Sand Springs**”

4.2 Community Elements

Designs should reflect key characteristics of the Sand Springs community, including:

- Industrial and business heritage
- Strong culture of generosity and community support
- Recognition of families and community values
- Local geography and outdoor lifestyle, including:
 - River and natural landscapes
 - Wildlife
 - Parks and trails
 - Cliffs, biking, hiking, and sports

4.3 Tone & Style

- Vibrant, welcoming, and community focused
- Designed to serve as a lasting visual landmark

5. Minimum Requirements

All proposals must meet the following requirements:

- Designs must be **tasteful and community-appropriate**
- Include a **designated interactive photo element** within the mural to encourage public engagement and social media use

- Provide a **final color palette** (Pantone or equivalent) for maintenance and future touch-ups
- Apply a **graffiti-resistant protective sealant** upon completion
- Provide a **detailed project timeline** from design approval through completion
- Agree to a **milestone-based payment structure**
- Demonstrate **proven experience** with large-scale mural projects of similar size and complexity

6. Proposal Submission Requirements

Interested artists must submit a complete proposal including:

6.1 Artist Qualifications

- Resume or portfolio highlighting relevant mural experience
- Examples of past large-scale or public art installations

6.2 Design Concept

- Concept sketches or digital renderings
- Narrative description of design approach and inspiration

6.3 Project Plan

- Proposed timeline with key milestones
- Installation methodology and materials to be used

6.4 Cost Proposal

- Total project cost, inclusive of all phases, shall not exceed \$20,000.00
- Breakdown by phase (design, materials, labor, sales, etc.)

6.5 References

- Minimum of three (3) professional references for similar work

7. Evaluation Criteria

Proposals will be evaluated based on the following weighted criteria:

Criteria	Weight
Artistic Quality & Technical Capability	30%
Alignment with Community Vision	25%
Experience & Past Performance	20%
Cost & Overall Value	15%
Project Timeline & Execution Plan	10%

8. Review & Award Process

- A **Review Committee** comprised of representatives from:
 - Sand Springs Chamber of Commerce
 - Osage Nation Gaming Enterprise
- Process:
 1. Initial review of all qualified submissions
 2. Selection of top three (3) finalists
 3. Finalists invited to present concepts and receive feedback in person
 4. Committee vote and final artist selection

ONGE reserves the right to reject any or all proposals and to request additional information as needed.

9. Terms & Conditions

- All artwork must be original and not infringe on any copyrights
- ONGE retains the right to use images of the mural for promotional purposes
- Final design must be approved prior to execution
- Vendor is responsible for all materials, labor, and site safety compliance